

BASE BIDS: AHS, GHS

PROJECT

2018 INTERIOR PAINTING AT:

AUBURN HIGH SCHOOL

5110 AUBURN STREET

ROCKFORD, IL 61101

GUILFORD HIGH SCHOOL

5620 SPRING CREEK ROAD

ROCKFORD, IL 61114

OWNER

ROCKFORD PUBLIC SCHOOLS 205

501 SEVENTH STREET

ROCKFORD, IL 61104

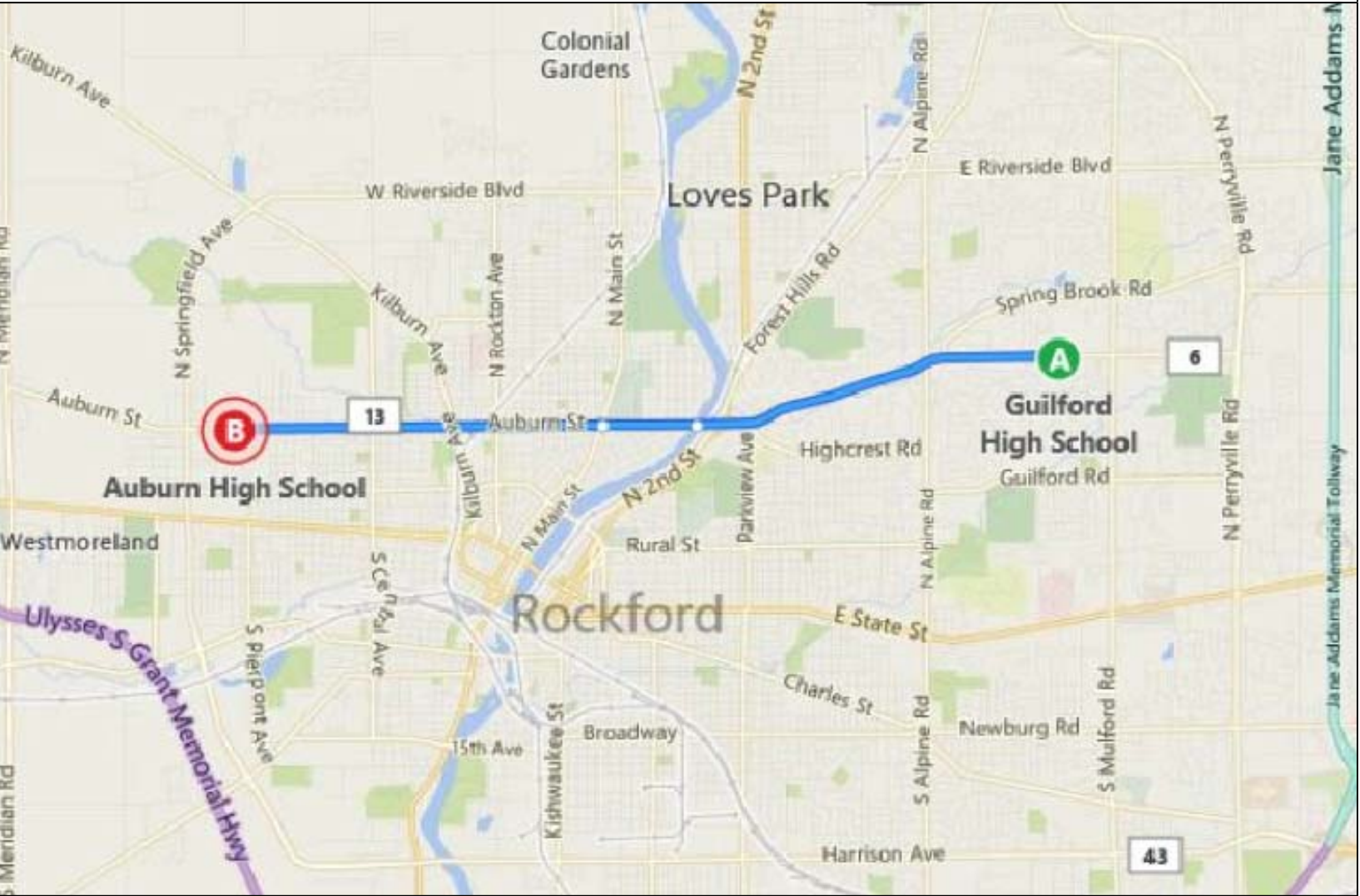
SHEET INDEX		REFERENCE MAP
T.1	TITLE SHEET	
AHS P1.0	AUBURN HIGH SCHOOL (PROJ # 1528) 1ST FLOOR PLAN	
AHS P2.0	2ND FLOOR PLAN	
GHS P1.0	GUILFORD HIGH SCHOOL (PROJ # 1529) 1ST FLOOR PLAN	
GHS P2.0	2ND FLOOR PLAN	

PAINT SCHEDULE:
CLASSROOMS:
BENJAMIN MOORE - 1472 SILVER CHAIN ON 3 WALLS PER ROOM (TYPICAL)
SHERWIN WILLIAMS - SW6321 RED BAY ON 1 ACENT WALL PER ROOM, TYPICALLY THE SIDE WALL OPPOSITE THE SMARTBOARD WALL (NOT WINDOW WALL, NOT CORRIDOR WALL, NOT SMARTBOARD WALL - IF IN DOUBT, CONTACT RPS PROJECT MANAGER)
CAFETERIA:
SHERWIN WILLIAMS - SW6385 DOVER WHITE

ALTERNATE BID:
DOOR FRAMES, STAIR RISERS, HANDRAILS:
BENJAMIN MOORE - HC-166 KENDALL CHARCOAL

GENERAL NOTES:
1. ALL VERTICAL SURFACES, INCLUDING BUT NOT LIMITED TO STRUCTURAL GLAZED TILE (CERAMIC TILE), GWB, CMU, SOFFITS, ETC. SHALL BE PAINTED WHERE INDICATED BY CROSS HATCH ON FLOOR PLANS.

2. PROTECT EXISTING FLOORS AND WALL BASE THROUGHOUT AGAINST DAMAGE OR STAINING.
3. WOOD DOORS SHALL REMAIN "AS IS".
4. ALL WORK SHALL BE PERFORMED IN COMPLIANCE WITH PROJECT SPECIFICATIONS AND CONTRACT DOCUMENTS.
5. PATCH AND PREPARE SURFACES TO CREATE "LIKE-NEW" CONDITIONS.
6. IN MATERIAL SCIENCES #730, PAINT ONLY THE FOLLOWING WALLS: WEST WALL; AND LIMITED PORTION OF SOUTH WALL AROUND EXIT DOOR INTO CORRIDOR.
7. IN CAFETERIA #143, PAINT ALL WALLS, AND THE UPPER HALF OF FOUR (4) FREE-STANDING COLUMNS, SW6385.

8. ALTERNATE BIDS:
 AHS ALT BID #1: PAINT ALL HOLLOW METAL FRAMES, ALL HOLLOW METAL DOORS BOTH SIDES AS SHOWN ON DOOR SCHEDULE. PER SPECIFICATIONS.
 AHS ALT BID #2: PAINT STAIR RISERS, STRINGERS, METAL HANDRAILS AND RAILINGS IN STAIRWELLS INDICATED. PER SPECIFICATIONS. (WOOD HANDRAILS SHALL REMAIN "AS IS.")

LEGEND:

7 HATCH INDICATES ROOMS OR AREAS TO BE PAINTED

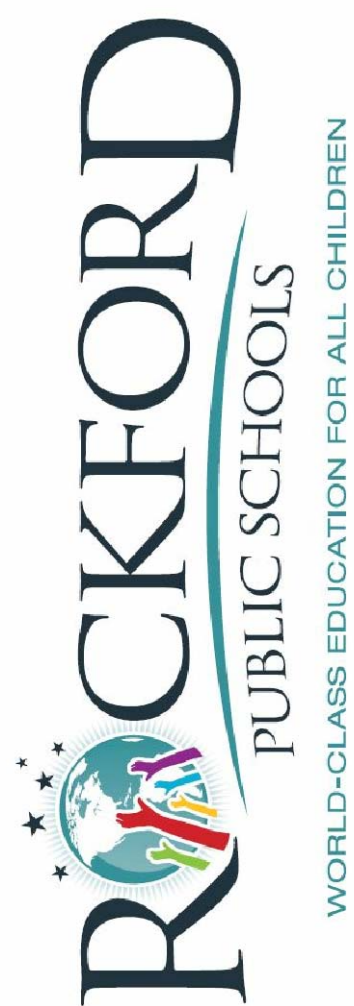

501 7TH STREET ROCKFORD, IL 61104

AUBURN HIGH SCHOOL - FINISHES

5110 AUBURN STREET
ROCKFORD, IL 61101

DATE:	04.10.2018	PROJECT:	2018 INTERIOR PAINTING
PROJECT NUMBER	1528-PT		-
SHEET NUMBER			
AHS P1.0		DRAWN BY:	

2018 PAINTING NOTES

PAINT SCHEDULE:
CLASSROOMS:
BENJAMIN MOORE - 1472 SILVER CHAIN ON 3 WALLS PER ROOM (TYPICAL)
SHERWIN WILLIAMS - SW6321 RED BAY ON 1 ACCENT WALL PER ROOM, TYPICALLY THE SIDE WALL OPPOSITE THE SMARTBOARD WALL, (NOT WINDOW WALL, NOT CORRIDOR WALL, NOT SMARTBOARD WALL - IF IN DOUBT, CONTACT RPS PROJECT MANAGER)
CAFETERIA:
SHERWIN WILLIAMS - SW6385 DOVER WHITE

ALTERNATE BID:
DOOR FRAMES, STAIR RISERS, HANDRAILS:
BENJAMIN MOORE - HC-166 KENDALL CHARCOAL

- GENERAL NOTES:
1. ALL VERTICAL SURFACES, INCLUDING BUT NOT LIMITED TO STRUCTURAL GLAZED TILE (CERAMIC TILE), GWB, CMU, SOFFITS, ETC. SHALL BE PAINTED WHERE INDICATED BY CROSS HATCH ON FLOOR PLANS.
 2. PROTECT EXISTING FLOORS AND WALL BASE THROUGHOUT AGAINST DAMAGE OR STAINING.
 3. WOOD DOORS SHALL REMAIN "AS IS".
 4. ALL WORK SHALL BE PERFORMED IN COMPLIANCE WITH PROJECT SPECIFICATIONS AND CONTRACT DOCUMENTS.
 5. PATCH AND PREPARE SURFACES TO CREATE "LIKE-NEW" CONDITIONS.
 6. IN MATERIAL SCIENCES #730, PAINT ONLY THE FOLLOWING WALLS: WEST WALL; AND LIMITED PORTION OF SOUTH WALL AROUND EXIT DOOR INTO CORRIDOR.
 7. IN CAFETERIA #143, PAINT ALL WALLS, AND THE UPPER HALF OF FOUR (4) FREE-STANDING COLUMNS, SW6385.
 8. ALTERNATE BIDS:
AHS ALT BID #1: PAINT ALL HOLLOW METAL FRAMES, ALL HOLLOW METAL DOORS BOTH SIDES AS SHOWN ON DOOR SCHEDULE. PER SPECIFICATIONS.
AHS ALT BID #2: PAINT STAIR RISERS, STRINGERS, METAL HANDRAILS AND RAILINGS IN STAIRWELLS INDICATED. PER SPECIFICATIONS. (WOOD HANDRAILS SHALL REMAIN "AS IS".)

LEGEND:
 HATCH INDICATES ROOMS OR AREAS TO BE PAINTED

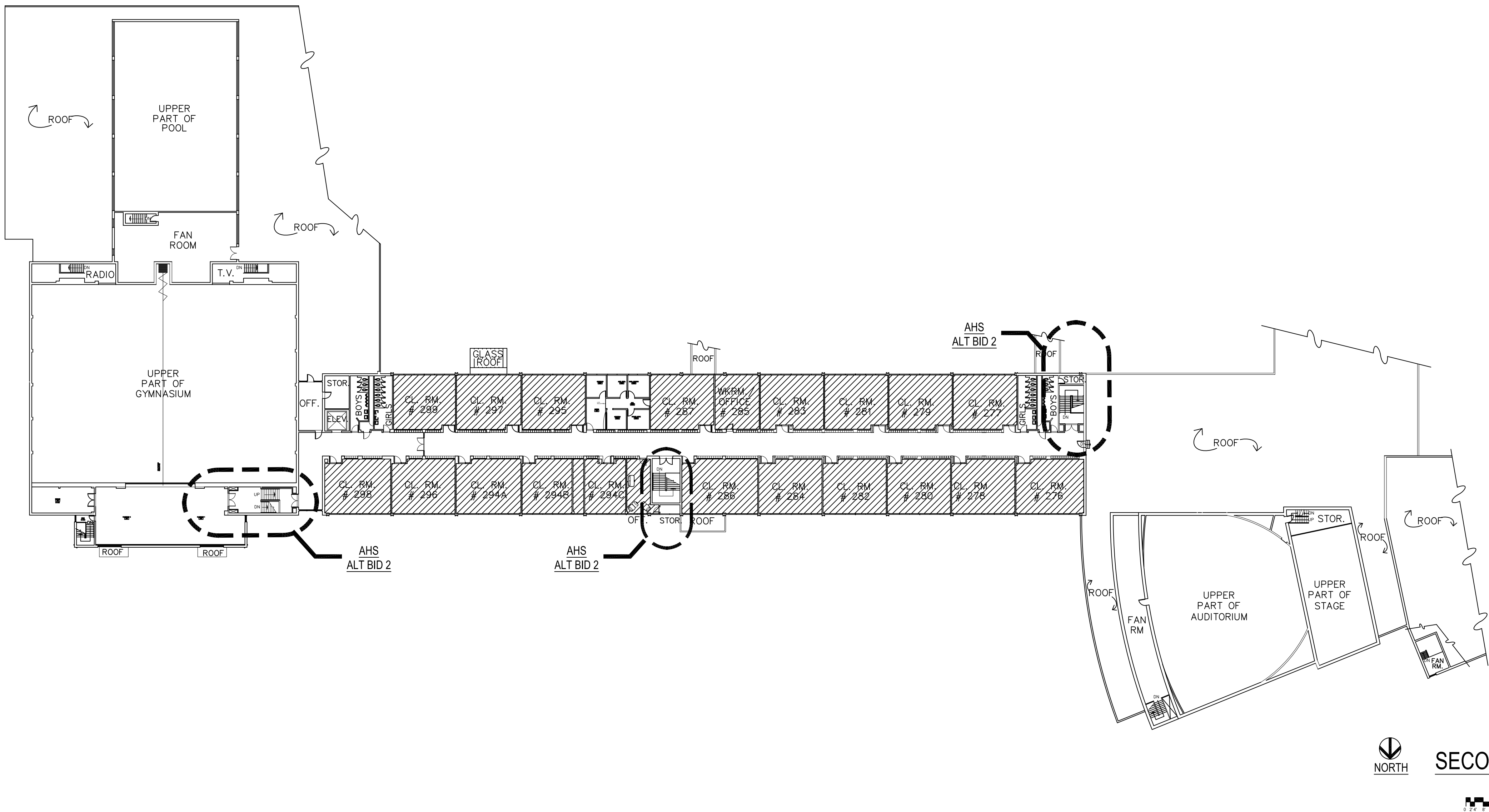

PAINT SCHEDULE:
SHERWIN WILLIAMS - SW6148 WOOL SKEIN ON 3 WALLS PER ROOM (TYPICAL)
BENJAMIN MOORE - 2061-30 BERMUDA BLUE (ACCENT COLOR) ON 1 ACCENT WALL PER ROOM, TYPICALLY THE WALL ADJACENT TO THE CORRIDOR (NOT WINDOW WALL, NOT SMARTBOARD WALL - IF IN DOUBT, CONTACT RPS PROJECT MANAGER)

ALTERNATE BID:
DOOR FRAMES, STAIR RISERS, HANDRAILS:
SHERWIN WILLIAMS - SW6991 BLACK MAGIC

- GENERAL NOTES:
1. ALL VERTICAL SURFACES, INCLUDING BUT NOT LIMITED TO GWB, CMU, SOFFITS, ETC. SHALL BE PAINTED WHERE INDICATED BY CROSS HATCH ON FLOOR PLANS.
 2. PROTECT EXISTING FLOORS AND WALL BASE THROUGHOUT AGAINST DAMAGE OR STAINING.
 3. WOOD DOORS SHALL REMAIN "AS IS".
 4. ALL WORK SHALL BE PERFORMED IN COMPLIANCE WITH PROJECT SPECIFICATIONS AND CONTRACT DOCUMENTS.
 5. PATCH AND PREPARE SURFACES TO CREATE "LIKE-NEW" CONDITIONS.
 6. IN COMMONS #A100, PAINT CMU ABOVE TILE ON NORTH WALL ACCENT COLOR. PAINT FASCIA SPANNING BETWEEN COLUMNS ACCENT COLOR. PAINT FIN TUBE UNDER WINDOWS ON WEST WALL SW6991 BLACK MAGIC. (NOTE: THIS AREA IS NOT HATCHED, BUT TO BE PAINTED PER THIS NOTE.)
 7. IN GYMNASIUM #G102, PAINT METAL VENT GRATES SW6991 BLACK MAGIC. (NOTE: THIS AREA IS NOT HATCHED.)
 8. IN CAFETERIA, ONLY PAINT FIN TUBE UNDER WINDOWS ON NORTH WALL SW6991 BLACK MAGIC. NO OTHER SURFACES IN THIS ROOM TO BE PAINTED. (NOTE: THIS AREA IS NOT HATCHED.)
 9. ALTERNATE BIDS:
GHS ALT BID #1: PAINT ALL HOLLOW METAL FRAMES, ALL HOLLOW METAL DOORS BOTH SIDES AS SHOWN ON DOOR SCHEDULE. PER SPECIFICATIONS.
GHS ALT BID #2: PAINT STAIR RISERS, STRINGERS, METAL HANDRAILS AND RAILINGS IN STAIRWELLS INDICATED. PER SPECIFICATIONS. (WOOD HANDRAILS SHALL REMAIN "AS IS".)

LEGEND:

 HATCH INDICATES ROOMS OR AREAS TO BE PAINTED

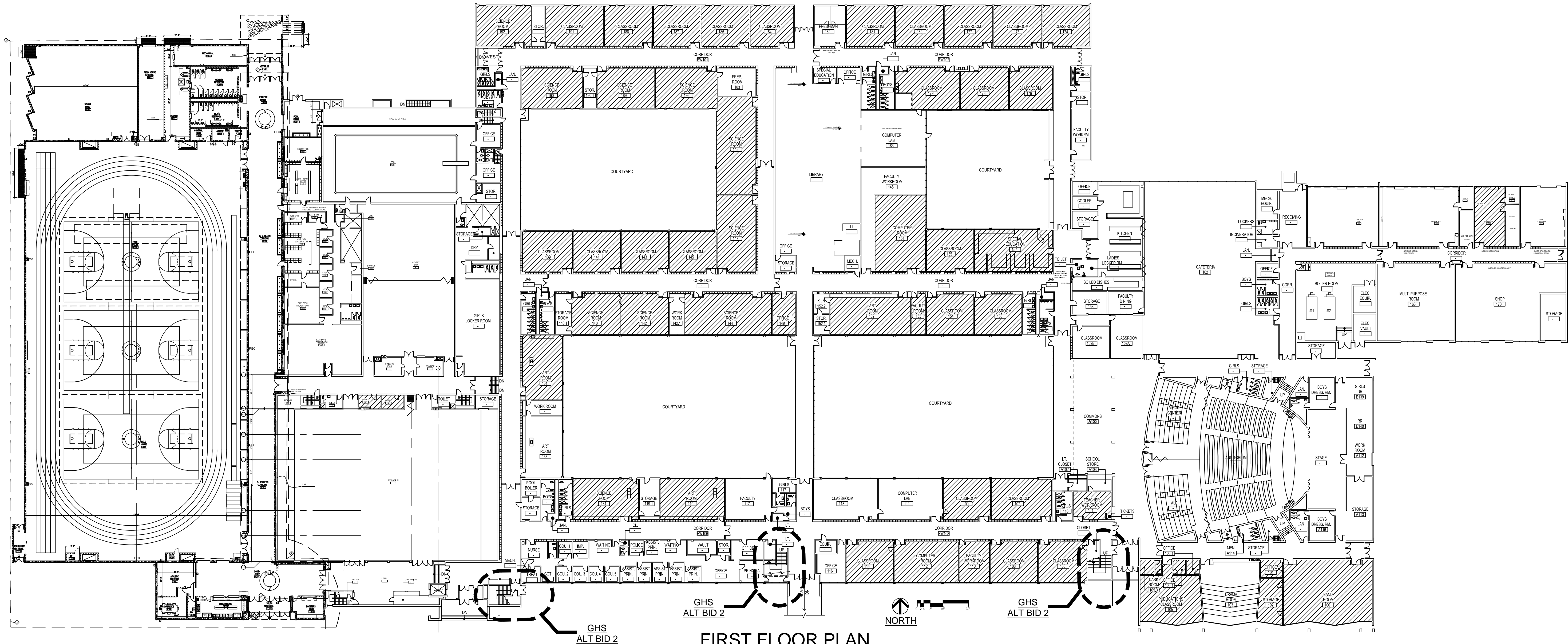

FIRST FLOOR PLAN

GUILFORD HIGH SCHOOL - FINISHES

5620 SPRING CREEK ROAD
ROCKFORD, IL 61114

DATE:	04.10.18	PROJECT:	2018 INTERIOR PAINTING
PROJECT NUMBER	1529		
SHEET NUMBER			
		DRAWN BY:	
GHS P1.0			

PAINT SCHEDULE:
SHERWIN WILLIAMS - SW6148 WOOL SKEIN ON 3 WALLS PER ROOM (TYPICAL)
BENJAMIN MOORE - 2061-30 BERMUDA BLUE (ACCENT COLOR) ON 1 ACCENT WALL PER ROOM, TYPICALLY THE WALL ADJACENT TO THE CORRIDOR (NOT WINDOW WALL, NOT SMARTBOARD WALL - IF IN DOUBT, CONTACT RPS PROJECT MANAGER)

ALTERNATE BID:
DOOR FRAMES, STAIR RISERS, HANDRAILS:
SHERWIN WILLIAMS - SW6991 BLACK MAGIC

GENERAL NOTES:
1. ALL VERTICAL SURFACES, INCLUDING BUT NOT LIMITED TO GWB, CMU, SOFFITS, ETC. SHALL BE PAINTED WHERE INDICATED BY CROSS HATCH ON FLOOR PLANS.

2. PROTECT EXISTING FLOORS AND WALL BASE THROUGHOUT AGAINST DAMAGE OR STAINING.

3. WOOD DOORS SHALL REMAIN "AS IS".

4. ALL WORK SHALL BE PERFORMED IN COMPLIANCE WITH PROJECT SPECIFICATIONS AND CONTRACT DOCUMENTS.

5. PATCH AND PREPARE SURFACES TO CREATE "LIKE-NEW" CONDITIONS.

6. IN COMMONS #A100, PAINT CMU ABOVE TILE ON NORTH WALL ACCENT COLOR. PAINT FASCIA SPANNING BETWEEN COLUMNS ACCENT COLOR. PAINT FIN TUBE UNDER WINDOWS ON WEST WALL SW6991 BLACK MAGIC. (NOTE: THIS AREA IS NOT HATCHED, BUT TO BE PAINTED PER THIS NOTE.)

7. IN GYMNASIUM #G102, PAINT METAL VENT GRATES SW6991 BLACK MAGIC. (NOTE: THIS AREA IS NOT HATCHED.)

8. IN CAFETERIA, ONLY PAINT FIN TUBE UNDER WINDOWS ON NORTH WALL SW6991 BLACK MAGIC. NO OTHER SURFACES IN THIS ROOM TO BE PAINTED. (NOTE: THIS AREA IS NOT HATCHED.)

9. ALTERNATE BIDS:
GHS ALT BID #1: PAINT ALL HOLLOW METAL FRAMES, ALL HOLLOW METAL DOORS BOTH SIDES AS SHOWN ON DOOR SCHEDULE. PER SPECIFICATIONS.
GHS ALT BID #2: PAINT STAIR RISERS, STRINGERS, METAL HANDRAILS AND RAILINGS IN STAIRWELLS INDICATED. PER SPECIFICATIONS. (WOOD HANDRAILS SHALL REMAIN "AS IS".)

LEGEND:
 HATCH INDICATES ROOMS OR AREAS TO BE PAINTED

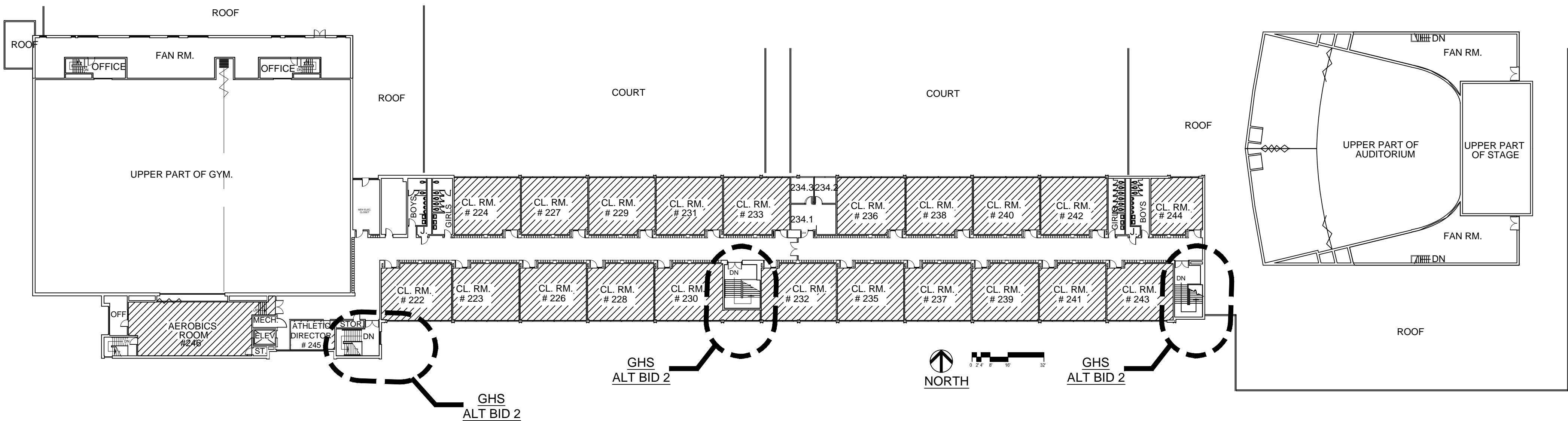

SECOND FLOOR PLAN



501 7TH STREET ROCKFORD, IL 61104

GUILFORD HIGH SCHOOL - FINISHES

5620 SPRING CREEK ROAD
ROCKFORD, IL 61114

DATE:	04.10.18	PROJECT:	2018 INTERIOR PAINTING
PROJECT NUMBER	1529		
SHEET NUMBER		DRAWN BY:	
GHS P2.0			