

## PROJECT

ELLIS ELEMENTARY SCHOOL 222 S. CENTRAL AVENUE, ROCKFORD, ILLINOIS 61102	RESA MIDDLE SCHOOL 1800 OGILBY ROAD ROCKFORD, ILLINOIS 61102
---	--

501 7TH STREET,  
ROCKFORD, ILLINOIS 61104

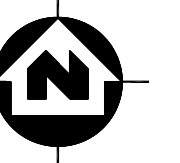
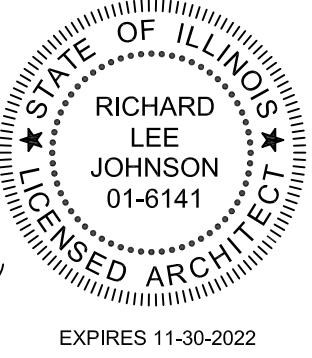

<b>ARCHITECT OF RECORD</b>							
<p>RICHARD L. JOHNSON ASSOCIATES 4703 Charles Street Rockford IL. 61108 PHONE: 815/398-1231 FAX 815/398-1280 www.rljarch.com IL. Design Firm No. 187-000524</p> 							
<b>SHEET INDEX</b>							
<u><b>TITLE SHEET</b></u>							
T101		TITLE SHEET					
<u><b>ARCHITECTURAL</b></u>							
A101		ELLIS ELEMENTARY SCHOOL - DEMOLITION AND REVISED FLOORING PLAN					
A102		ELLIS ELEMENTARY SCHOOL - PARTIAL FLOORING PATTERN PLAN					
A103		ELLIS ELEMENTARY SCHOOL - PARTIAL FLOORING PATTERN PLAN					
A104		ELLIS ELEMENTARY SCHOOL - PARTIAL FLOORING PATTERN PLAN					
A105		ELLIS ELEMENTARY SCHOOL - PARTIAL FLOORING PATTERN PLAN					
A106		ELLIS ELEMENTARY SCHOOL - DEMOLITION AND REVISED PAINTING PLAN					
A107		RESA MIDDLE SCHOOL - DEMOLITION AND REVISED FLOORING PLANS - FOR REFERENCE ONLY					
A108		RESA MIDDLE SCHOOL - DEMOLITION AND REVISED PAINTING PLANS					

**ROCKFORD PUBLIC S**  
ROCKFORD, ILLINOIS

**RICHARD L. JOHNSON**  
ASSOCIATES | ARCHITECTS

---

MILE SHEET

Date	January 21, 2021
Rev. Date	
RLJA Proj	2020-066, -068

SHEET NUMBER

101

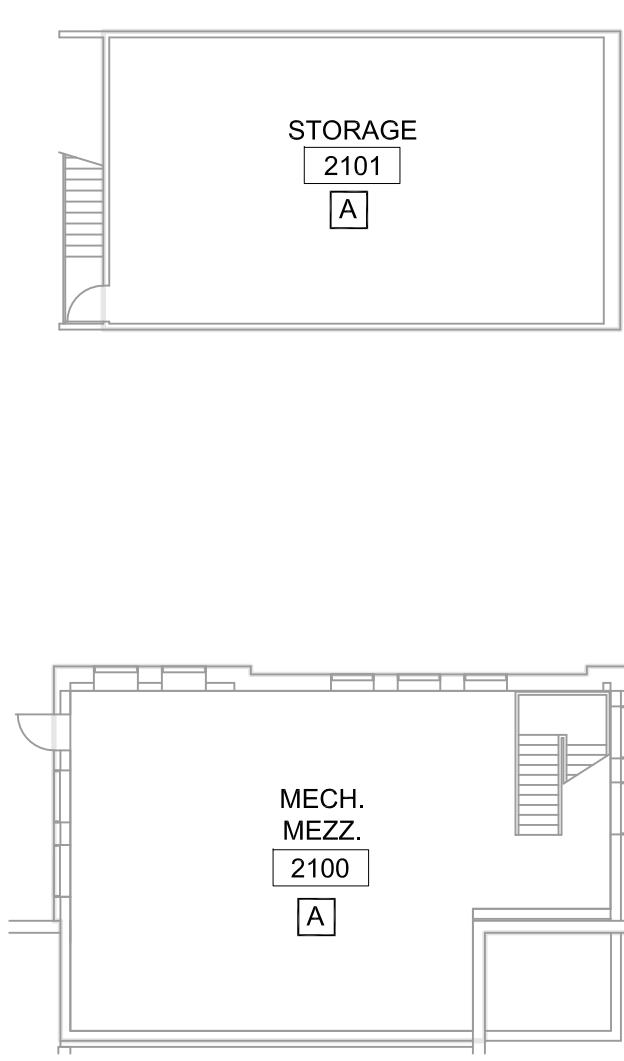
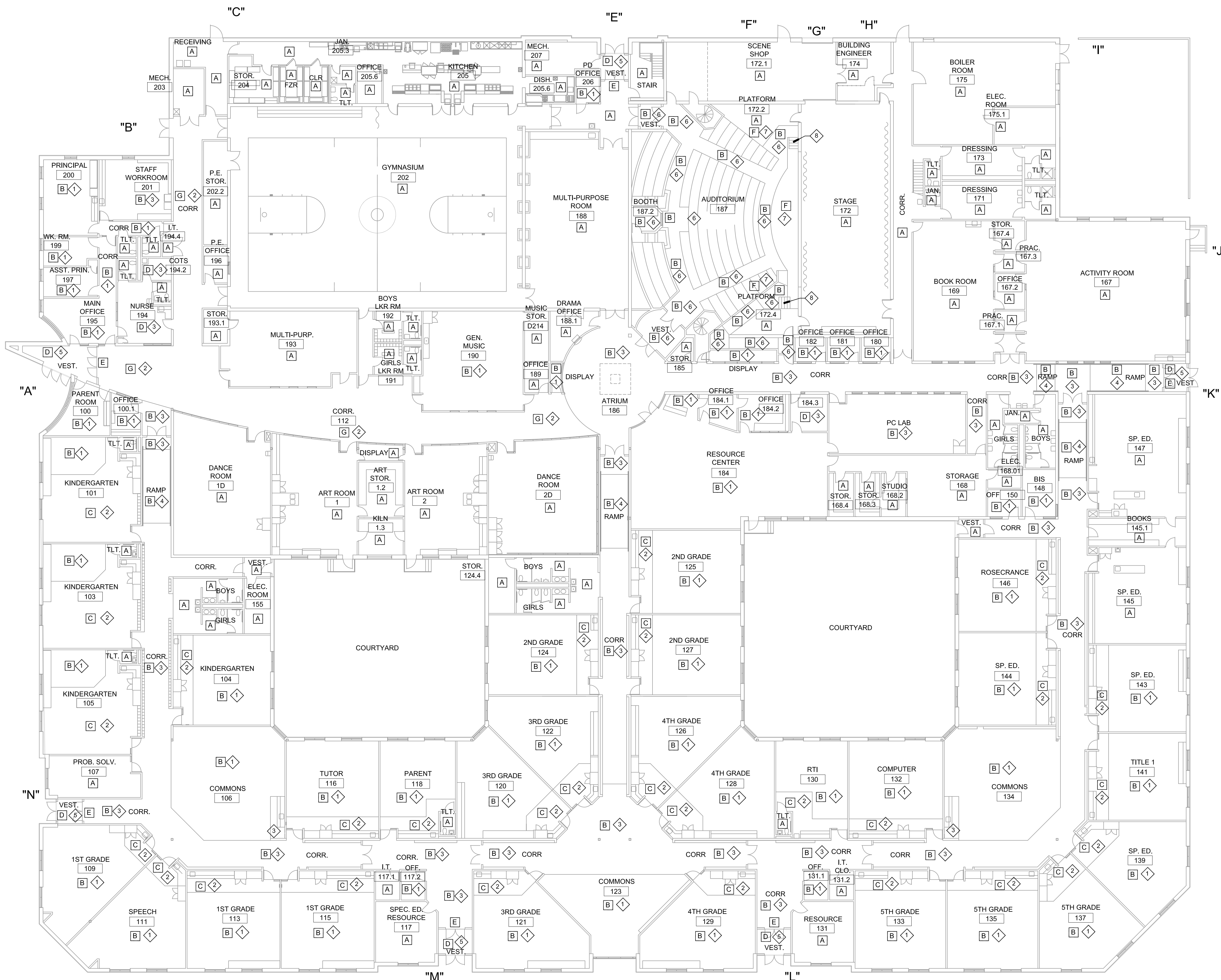

- FLOORING DEMOLITION KEY NOTES**
- A NO WORK IN THIS AREA.
  - B REMOVE CARPET, ADHESIVE, TRANSITION STRIPS AND EXISTING BASE.
  - C LEAVE VINYL COMPOSTION TILE AND REMOVE EXISTING BASE.
  - D REMOVE VINYL COMPOSITION TILE, ADHESIVE AND EXISTING BASE.
  - E REMOVE ALUMINUM THRESHOLD BETWEEN VESTIBULE AND CORRIDOR.
  - F REMOVE CARPET AND ADHESIVE FROM STAGE AND PLATFORM WALLS.
  - G REMOVE RUBBER BASE.

- FLOORING GENERAL NOTES**
1. FLOORING CONTRACTOR TO PREPARE FLOORS TO RECEIVE NEW FLOORING AS CALLED FOR IN PROJECT MANUAL AT AREAS WHERE NEW FLOORING IS PROPOSED.
  2. FLOORING CONTRACTOR TO VERIFY EXISTING FLOORING CONDITIONS AND FLOOR LEVELS AND PROVIDE LEVELING, LEVEL TRANSITIONS AS REQUIRED FOR NEW FLOORING. INSTALLATION AND PROVIDE NEW TRANSITION STRIPS AS REQUIRED WHERE NEW FLOORING MEETS EXISTING FLOORING.
  3. ALL DOORS TO REMAIN. VERIFY FLOOR CLEARANCE AND COORDINATE WITH TRANSITION STRIP COMPATIBILITY.
  4. FLOORING CONTRACTOR TO CUT DOWN EXISTING WOOD OR METAL DOORS AS REQUIRED TO ACCOMMODATE HEIGHT OF NEW FLOORING AND TRANSITION STRIPS.
  5. ALL WORK SHALL BE EXECUTED IN COMPLIANCE WITH ALL APPLICABLE FEDERAL, STATE AND LOCAL CODES, LAWS AND REGULATIONS. IF IN THE EVENT THAT HAZARDOUS MATERIAL HAS BEEN DISCOVERED ON SITE, STOP ALL WORK AND INFORM THE OWNER PRIOR TO ANY WORK MOVING FORWARD.
  6. FLOORING CONTRACTOR TO VERIFY ALL CONDITIONS AND DIMENSIONS AND REPORT ANY DISCREPANCIES TO ARCHITECT OR OWNER IMMEDIATELY.
  7. INSTALLATION OF FLOORING, BASE AND TRANSITIONS SHALL BE IN COMPLIANCE WITH MANUFACTURER'S SPECIFICATIONS.
  8. FLOORING CONTRACTOR TO VERIFY LAYOUT OF NEW FLOORING PATTERN WITH ARCHITECT PRIOR TO START OF INSTALLATION.
  9. PROVIDE 4" RUBBER COVE BASE UNDER CABINETRY.
  10. PROVIDE 4" RUBBER COVE WALL BASE.
  11. PROVIDE AND INSTALL TRANSITION STRIPS BETWEEN DISSIMILAR FLOOR FINISHES. SEE SPECIFICATIONS.
  12. INSTALL TRANSITION STRIPS AT DOOR FRAMES TO CORRIDOR FLUSH WITH DOOR STOPS AND AT INSIDE OF DOOR FACE.
  13. PROVIDE SKIM COAT TO ALL AREAS TO RECEIVE NEW FLOORING - SEE SPECIFICATIONS.
  14. APPLY ACRYL-A-SEAL SEALER BY BONE DRY TO ALL AREAS TO RECEIVE NEW FLOORING - SEE SPECIFICATIONS.
  15. SEE SPECIFICATIONS FOR FLOORING TYPES, STYLES, COLORS, PATTERNS AND INSTALLATION REQUIREMENTS. SEE FLOORING PATTERN PLANS.

- FLOORING KEY NOTES**
- 1 INSTALL NEW CARPET TILE FLOORING, TRANSITION STRIPS AND 4" RUBBER BASE.
  - 2 INSTALL NEW 4" RUBBER BASE.
  - 3 INSTALL NEW LVT FLOORING, TRANSITION STRIPS AND 4" RUBBER BASE.
  - 4 INSTALL NEW RUBBER FLOOR TILE AND 4" RUBBER BASE.
  - 5 INSTALL WALK-OFF CARPET TILE, TRANSITION STRIPS AND 4" RUBBER BASE.
  - 6 INSTALL NEW CARPET FLOORING AND TRANSITION STRIPS.
  - 7 INSTALL NEW BROADLOOM CARPET ON STAGE AND PLATFORM VERTICAL WALLS.
  - 8 INSTALL NEW BROADLOOM CARPET ON STAIR RISERS, TREADS AND SIDE OF STAIR.





1

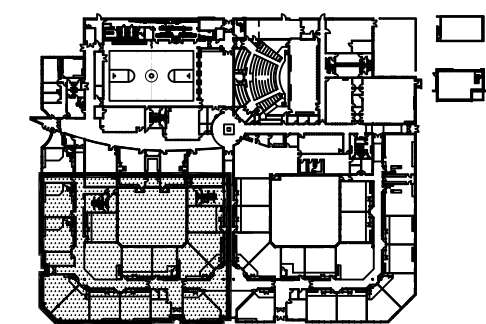

A102  
OF  
8





**CARPET AND LVT**

CPT - CARPET TILE

-CPT-1 AND CPT-2 FIELD, GLITCH ART - MAINBOARD AND RE-FORMAT 24" X 24"  
50/50% RANDOM MIX, ASHLAR INSTALLATION  
-CPT-3 ACCENT. COLOR ANCHOR/SQUAWK 24" X 24" (BLUE)  
-CPT-4 ACCENT. COLOR ANCHOR/FLOWERISTA 24" X 24" (ORANGE)  
-CPT-5 ACCENT. COLOR ANCHOR/MEADOW 24" X 24" (GREEN)

FOR CPT-3, CPT-4, CPT-5 - SEE SPECIFICATIONS FOR CUSTOM COLOR  
DIRECTION  
PROVIDE CARPET PATTERN INSTALLATION AS SHOWN AND AS LISTED BELOW.

WALK OFF CARPET MANUFACTURER: SHAW

CPT-6 SHAW WALK OFF -  
24" X 24" CARPET TILES  
COLLECTION/COLOR: STEPPIN OUT ENTRÉE TILE  
COLOR - CHARCOAL 31549  
INSTALLATION METHOD - QUARTERTURNED  
SEE SHEET A101 FOR VESTIBULE LOCATIONS TO RECEIVE WALKOFF CARPET.

LVT - LUXURY VINYL TILE

-LVT-1 FIELD. COLOR ANCHOR - GROOVE/CHINCHILLA 6" X 36" (GREY)  
-LVT-2 ACCENT. COLOR ANCHOR - STRIDE/SUGARSNAP 6" X 36" (LIME)  
-LVT-3 ACCENT. COLOR ANCHOR - STRIDE/SQUAWK BOX 6" X 36" (BLUE)  
-LVT-4 ACCENT. COLOR ANCHOR - STRIDE/SQUASH BLOSSOM 6" X 36" (ORANGE)  
-LVT-5 ACCENT. COLOR ANCHOR - STRIDE/MILK THISTLE 6" X 36" (PURPLE)

PROVIDE LVT PATTERN INSTALLATION AS SHOWN.

RT - RUBBER TILE

RT -1 COLOR ANCHOR RUBBER - COLOR/SPEC/FLINT 18" X 18" - STANDARD GRID  
INSTALLATION

R8 RUBBER BASE

RUBBER BASE AND TRANSITION STRIPS MANUFACTURER: MANNINGTON  
4" BASE. COLOR: 153 BLACK BROWN

NOTES

SEE SHEET A101 FOR ALL FLOORING, BASE, TRANSITION LOCATIONS.  
SEE SPECIFICATIONS SECTIONS 096519 RESILIENT FLOORING AND BASE  
096813 CARPET TILE

CARPET, LVT, RUBBER TILE, RUBBER BASE, FOR CUSTOM COLOR  
MANUFACTURER: MANNINGTON

PROVIDE BROADLOOM CARPET IN AUDITORIUM ON STAIRS AT STAGE, AND  
ALL VERTICAL WALLS ADJACENT TO STAGE FLOOR AND PLATFORM WHERE  
EXISTING CARPET WAS REMOVED DURING DEMO. BROADLOOM CARPET IN  
SAME COLOR AS CPT-2.

ALL CLASSROOMS - ASHLAR INSTALLATION METHOD: INSTALL TWO FIELD  
COLOR TILES RANDOMLY MIXED 50% OF EACH. PLACE RANDOMLY,  
CREATING NO VISUAL PATTERN BETWEEN THE TWO TILES.  
INCLUDE 3 ACCENT TILES EQUALLY AT A 5% TOTAL QUANTITY IN THE FIELD  
TILES, RANDOMLY PLACED. SEE PLAN - "TYPICAL CLASSROOM  
PATTERN" AND LOCATIONS.

COMMONS 106, 123, 134, RESOURCE CENTER 184, GENERAL MUSIC 190,  
SAME INSTALLATION AS CLASSROOMS, EXCEPT INSTALL ACCENT TILES AS  
SHOWN, IN GROUPS PER ACCENT COLOR.

THE FOLLOWING ROOMS SHALL RECEIVE CPT-1 and CPT-2 FIELD CARPET  
TILES IN TYPICAL ASHLAR RANDOM MIX, WITH NO ACCENT CARPET AS  
SHOWN:  
AUDITORIUM 187 INCLUDING VESTIBULES, BOOTH 187.2, PLATFORM 174.2  
RAMP AND LANDINGS, MAIN OFFICE 195, ASST. PRINCIPAL 197, WORKROOM  
198, PRINCIPAL 200, CORRIDORS IN OFFICE SUITE, PARENT ROOM 100,  
OFFICE 100.1, KINDERGARTEN 101, 103, 105, OFFICE 117.2, OFFICE 131.1,  
OFFICE 150, BIS 148, OFFICE 180, 181, 182, 2 DISPLAY AREAS,  
OFFICE 184.1, 184.2, OFFICE 206.

PROVIDE TRANSITION STRIPS WHEREVER TWO FLOORING TYPES MEET OR  
AS REQUIRED AT EDGES.  
150 AT TRANSITIONS BETWEEN NEW LVT AND CARPET TILE.  
152 AT TRANSITIONS BETWEEN EXISTING VCT AND CARPET TILE.  
FIELD VERIFY FOR CORRECT TRANSITION AND NOTIFY ARCHITECT PRIOR  
TO ORDERING ALL MATERIALS IF A PROFILE IS REQUIRED IN LIEU OF 150 OR  
152 AT SPECIFIC LOCATIONS.  
COLOR: 153 BLACK BROWN





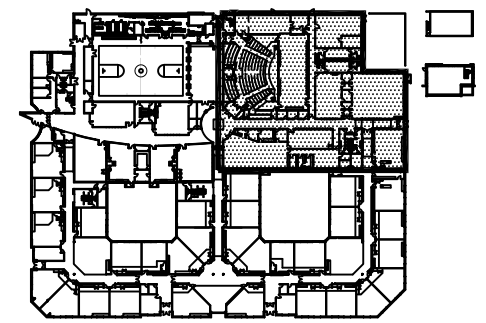

A104  
OF  
8



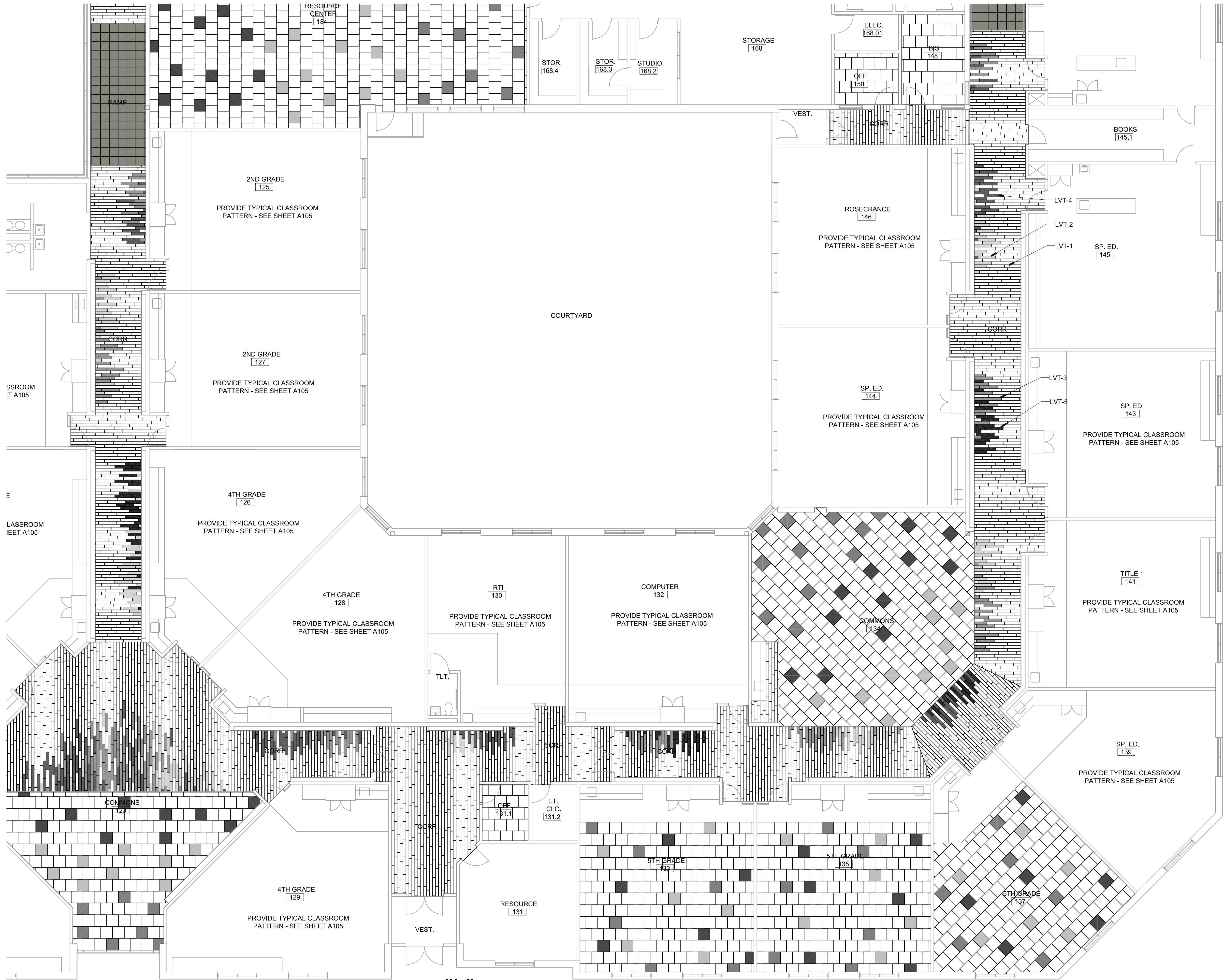

CARPET KEY	LVT KEY	RT KEY
CPT-1/ CPT-2:	LVT-1:	RT-1:
CPT-3:	LVT-2:	
CPT-4:	LVT-3:	
CPT-5:	LVT-4:	
	LVT-5:	

CARPET AND LVT

CPT - CARPET TILE

-CPT-1 AND CPT-2 FIELD. GLITCH ART - MAINBOARD AND RE-FORMAT 24" X 24" 50/50% RANDOM MIX, ASHLAR INSTALLATION  
-CPT-3 ACCENT. COLOR ANCHOR/SQUAWK 24" X 24" (BLUE)  
-CPT-4 ACCENT. COLOR ANCHOR/FLOWERISTA 24" X 24" (ORANGE)  
-CPT-5 ACCENT. COLOR ANCHOR/MEADOW 24" X 24" (GREEN)

FOR CPT-3, CPT-4, CPT-5 - SEE SPECIFICATIONS FOR CUSTOM COLOR DIRECTION  
PROVIDE CARPET PATTERN INSTALLATION AS SHOWN AND AS LISTED BELOW.

WALK OFF CARPET MANUFACTURER: SHAW

CPT-6 SHAW WALK OFF -  
24" x 24" CARPET TILES  
COLLECTION/COLOR: STEPPIN OUT ENTRÉE TILE  
COLOR - CHARCOAL 31549  
INSTALLATION METHOD - QUARTER TURNED  
SEE SHEET A101 FOR VESTIBULE LOCATIONS TO RECEIVE WALKOFF CARPET.

LVT - LUXURY VINYL TILE

-LVT-1 FIELD. COLOR ANCHOR - GROOVE/CHINCHILLA 6" X 36" (GREY)  
-LVT-2 ACCENT. COLOR ANCHOR - STRIDE/SUGAR SNAP 6" X 36" (LIME)  
-LVT-3 ACCENT. COLOR ANCHOR - STRIDE/SQUAWK BOX 6" X 36" (BLUE)  
-LVT-4 ACCENT. COLOR ANCHOR - STRIDE/SQUASH BLOSSOM 6" X 36" (ORANGE)  
-LVT-5 ACCENT. COLOR ANCHOR - STRIDE/MILK THISTLE 6" X 36" (PURPLE)

PROVIDE LVT PATTERN INSTALLATION AS SHOWN.

RT RUBBER TILE

RT - 1 COLOR ANCHOR RUBBER - COLOR SPEC/FLINT 18" X 18" - STANDARD GRID INSTALLATION

RB RUBBER BASE

RUBBER BASE AND TRANSITION STRIPS MANUFACTURER: MANNINGTON  
4" BASE, COLOR: 153 BLACK BROWN

NOTES

SEE SHEET A101 FOR ALL FLOORING, BASE, TRANSITION LOCATIONS.

SEE SPECIFICATIONS SECTIONS 096519 RESILIENT FLOORING AND BASE 096813 CARPET TILE

CARPET, LVT, RUBBER FLOOR, RUBBER BASE, AND TRANSITIONS MANUFACTURER: MANNINGTON

PROVIDE BROADLOOM CARPET IN AUDITORIUM ON STAIRS AT STAGE, AND ALL VERTICAL WALLS ADJACENT TO STAGE FLOOR AND PLATFORM WHERE EXISTING CARPET WAS REMOVED DURING DEMO. BROADLOOM CARPET IN SAME COLOR AS CPT-2.

ALL CLASSROOMS - ASHLAR INSTALLATION METHOD. INSTALL TWO FIELD CARPET TILES RANDOMLY MIXED 50% OF EACH. PLACE RANDOMLY, CREATING NO VISUAL PATTERN BETWEEN THE TWO TILES. INCLUDE 3 ACCENT TILES EQUALLY AT A 5% TOTAL QUANTITY IN THE FIELD TILES, RANDOMLY PLACED. SEE PLAN - 'TYPICAL CLASSROOM PATTERN' AND LOCATIONS.

COMMONS 108, 123, 134, RESOURCE CENTER 184, GENERAL MUSIC 190, SAME INSTALLATION AS CLASSROOMS, EXCEPT INSTALL ACCENT TILES AS SHOWN, IN GROUPS PER ACCENT COLOR.

THE FOLLOWING ROOMS SHALL RECEIVE CPT-1 and CPT-2 FIELD CARPET TILES IN TYPICAL ASHLAR RANDOM MIX, WITH NO ACCENT CARPET AS SHOWN:  
AUDITORIUM 187 INCLUDING VESTIBULES, BOOTH 187.2, PLATFORM 174.2 RAMP AND LANDINGS, MAIN OFFICE 195, ASST. PRINCIPAL 197, WORKROOM 199, PRINCIPAL 200, CORRIDORS IN OFFICE SUITE, PARENT ROOM 100, OFFICE 100.1, KINDERGARTEN 101, 103, 105, OFFICE 117.2, OFFICE 131.1, OFFICE 150, BIS 148, OFFICE 180, 181, 182, 2 DISPLAY AREAS, OFFICE 184.1, 184.2, OFFICE 206.

PROVIDE TRANSITION STRIPS WHEREVER TWO FLOORING TYPES MEET OR AS REQUIRED AT EDGES.  
150 AT TRANSITIONS BETWEEN NEW LVT AND CARPET TILE.  
152 AT TRANSITIONS BETWEEN EXISTING VCT AND CARPET TILE.  
FIELD VERIFY FOR CORRECT TRANSITION AND NOTIFY ARCHITECT PRIOR TO ORDERING ALL MATERIALS IF A PROFILE IS REQUIRED IN LIEU OF 150 OR 152 AT SPECIFIC LOCATIONS.  
COLOR: 153 BLACK BROWN

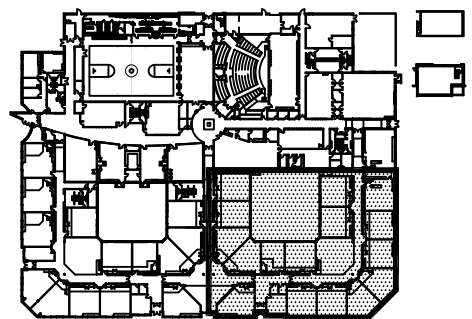

KEY PLAN

"L"

TYPICAL CLASSROOM PATTERN

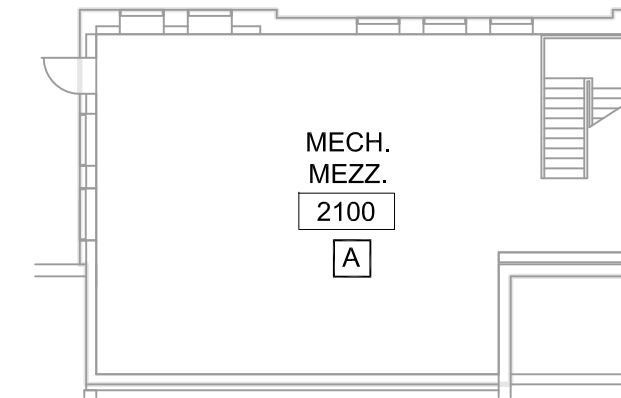

**A** NO WORK IN THIS AREA.

1. PREPARE CORRIDOR STEEL COLUMNS, METAL LOCKERS AND METAL HANDRAILS FOR PAINTING AS CALLED FOR IN PROJECT MANUAL.
2. ALL AREAS, FINISHED AND ITEMS NOT REQUIRING DEMOLITION MUST BE PROTECTED DURING DEMOLITION AND PAINTING WORK.
3. PAINT BOTH SIDES OF CORRIDOR DOOR FRAMES LEADING INTO ROOMS 101 THROUGH 144 AND TOILET ROOM DOOR FRAMES WITHIN THESE ROOMS PT-1.
4. PAINT CORRIDOR DOOR FRAMES ACCENT COLOR ON EACH SIDE OF CORRIDOR DOOR FRAME AS NOTED ON PAINT PLAN.

- 1 PAINT CORRIDOR EXTERIOR METAL LOCKER DOORS AND DOOR EDGES PT-1.
- 2 PAINT METAL HANDRAILS AND SUPPORTS AT RAMPS PT-1.
- 3 PAINT STEEL COLUMNS PT-1.
- 4 PAINT BOTH SIDES OF DOOR FRAME PT-6.
- 5 PAINT BOTH SIDES OF DOOR FRAME PT-2.
- 6 PAINT DOOR FRAME PT-2.
- 7 PAINT DOOR FRAME PT-3.
- 8 PAINT DOOR FRAME PT-4.
- 9 PAINT BOTH SIDES OF DOOR FRAME PT-4.
- 10 PAINT BOTH SIDES OF DOOR FRAME PT-5.
- 11 PAINT BOTH SIDES OF DOOR FRAME PT-3.
- 12 PAINT BOTH SIDES OF THE INTERIOR VESTIBULE DOOR FRAMES AND DOORS PT-1.
- 13 PAINT BOTH SIDES OF THE DOORS IN CORRIDOR PT-1.

PT-1	SW-7016 MINDFUL GRAY
PT-2	SW-6890 OSAGE ORANGE
PT-3	SW-6710 MELANGE GREEN
PT-4	SW-6945 BELIZE
PT-5	SW-6969 INDULGENT
PT-6	SW-6620 REJUVENATE





THIS DRAWING SHEET IS FOR REFERENCE ONLY - THE SCHOOL DISTRICT WILL BE COMPLETING ALL THE FLOORING WORK FOR RESA

## FLOORING DEMOLITION KEY NOTES

- ☐ A NO WORK IN THIS AREA.
- ☐ B REMOVE CARPET, ADHESIVE, TRANSITION STRIPS AND EXISTING BASE.
- ☐ C OMIT.
- ☐ D REMOVE ALUMINUM THRESHOLD BETWEEN VESTIBULE AND CORRIDOR.
- ☐ E REMOVE VCT FLOORING, ADHESIVE AND EXISTING BASE.

## FLOORING GENERAL NOTES

1. DISTRICT TRADESMEN TO PREPARE FLOORS TO RECEIVE NEW FLOORING AS CALLED FOR IN PROJECT MANUAL AT AREAS WHERE NEW FLOORING IS PROPOSED.
2. DISTRICT TRADESMEN TO VERIFY EXISTING FLOORING CONDITIONS AND FLOOR LEVELS AND PROVIDE LEVELING, LEVEL TRANSITIONS AS REQUIRED FOR NEW FLOORING, INSTALLATION AND PROVIDE NEW TRANSITION STRIPS AS REQUIRED WHERE NEW FLOORING MEETS EXISTING FLOORING.
3. ALL DOORS TO REMAIN. VERIFY FLOOR CLEARANCE AND COORDINATE WITH TRANSITION STRIP COMPATIBILITY.
4. DISTRICT TRADESMEN TO CUT DOWN EXISTING WOOD DOORS AS REQUIRED TO ACCOMMODATE HEIGHT OF NEW FLOORING AND TRANSITION STRIPS.
5. ALL WORK TO BE DONE IN COMPLIANCE WITH ALL APPLICABLE FEDERAL, STATE AND LOCAL CODES, LAWS AND REGULATIONS. IF IN THE EVENT THAT HAZARDOUS MATERIAL HAS BEEN DISCOVERED ON SITE, STOP ALL WORK AND INFORM THE OWNER PRIOR TO ANY WORK MOVING FORWARD.
6. DISTRICT TRADESMEN TO VERIFY ALL CONDITIONS AND DIMENSIONS AND REPORT ANY DISCREPANCIES TO ARCHITECT OR OWNER IMMEDIATELY.
7. INSTALLATION OF FLOORING, BASE AND TRANSITIONS SHALL BE IN COMPLIANCE WITH MANUFACTURER'S SPECIFICATIONS.
8. DISTRICT TRADESMEN TO VERIFY LAYOUT OF NEW FLOORING PATTERN WITH ARCHITECT PRIOR TO START OF INSTALLATION.
9. PROVIDE 4" RUBBER COVE BASE UNDER CABINETY.
10. PROVIDE 4" RUBBER COVE WALL BASE.
11. PROVIDE AND INSTALL NEW TRANSITION STRIPS BETWEEN DISSIMILAR FLOOR FINISHES, SURFACES.
12. INSTALL TRANSITION STRIPS AT DOOR FRAMES TO CORRIDOR FLUSH WITH DOOR STOPS AND AT INSIDE OF DOOR FACE.
13. PROVIDE SKIM COAT TO ALL AREAS TO RECEIVE NEW FLOORING - SEE SPECIFICATIONS.
14. APPLY ACRYL-A-SEAL SEALER BY BONE DRY TO ALL AREAS TO RECEIVE NEW FLOORING - SEE SPECIFICATIONS.
15. SEE SPECIFICATIONS FOR FLOORING TYPE, STYLES, COLORS, PATTERNS AND INSTALLATION REQUIREMENTS.

## FLOORING KEY NOTES

- 1 INSTALL NEW CARPET TILE FLOORING, TRANSITION STRIPS AND 4" RUBBER BASE.
- 2 INSTALL NEW LVT FLOORING, TRANSITION STRIPS AND 4" RUBBER BASE.
- 3 INSTALL 4" RUBBER BASE.
- 4 INSTALL WALK-OFF CARPET TILE, TRANSITION STRIPS AND 4" RUBBER BASE.

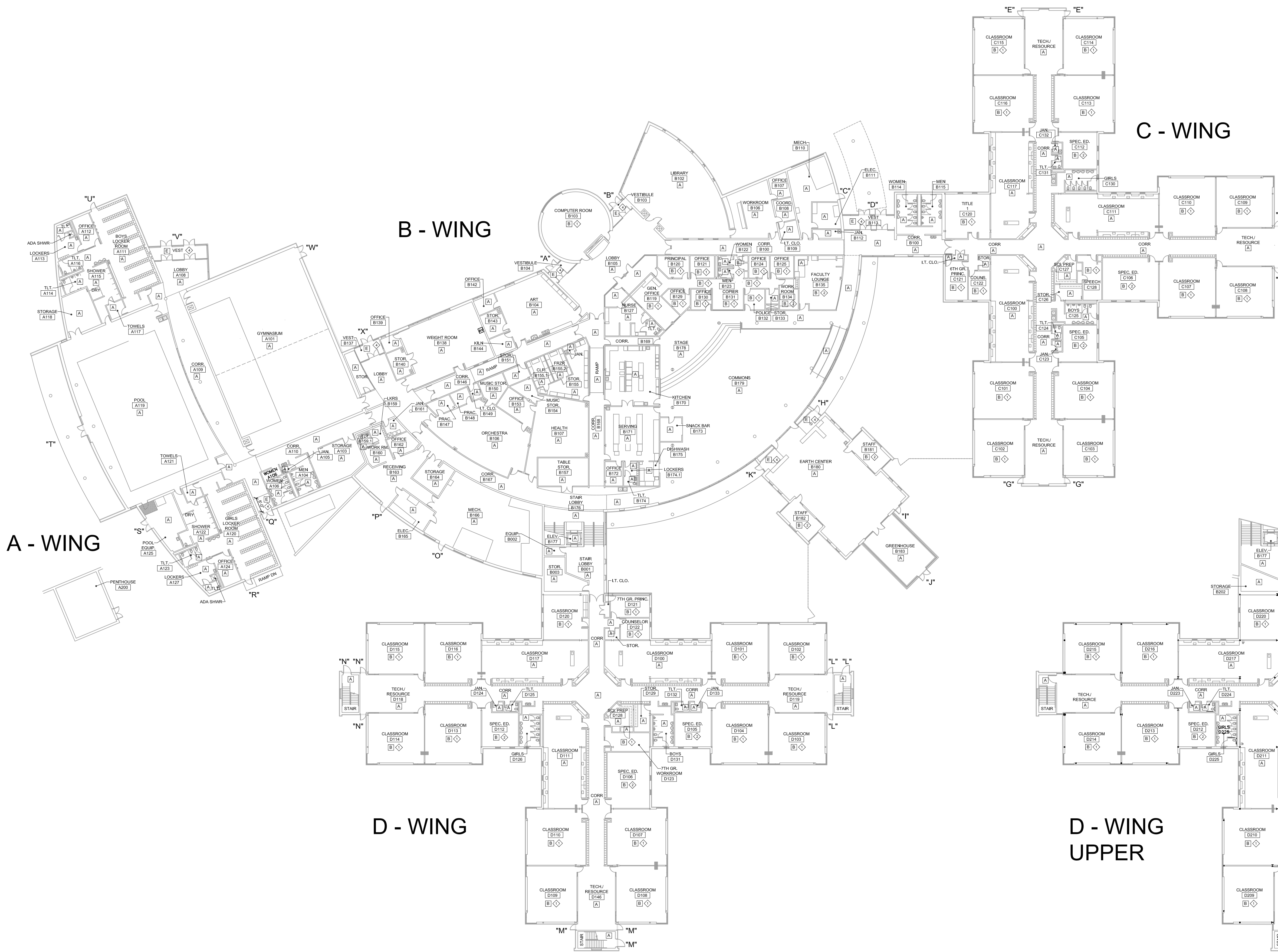

RESA MIDDLE SCHOOL  
DEMOLITION AND REVISED FLOORING PLAN

SCALE: 1/32"=1'-0"

RESA MIDDLE SCHOOL  
DEMOLITION AND REVISED FLOORING PLAN

SCALE: 1/32"=1'-0"



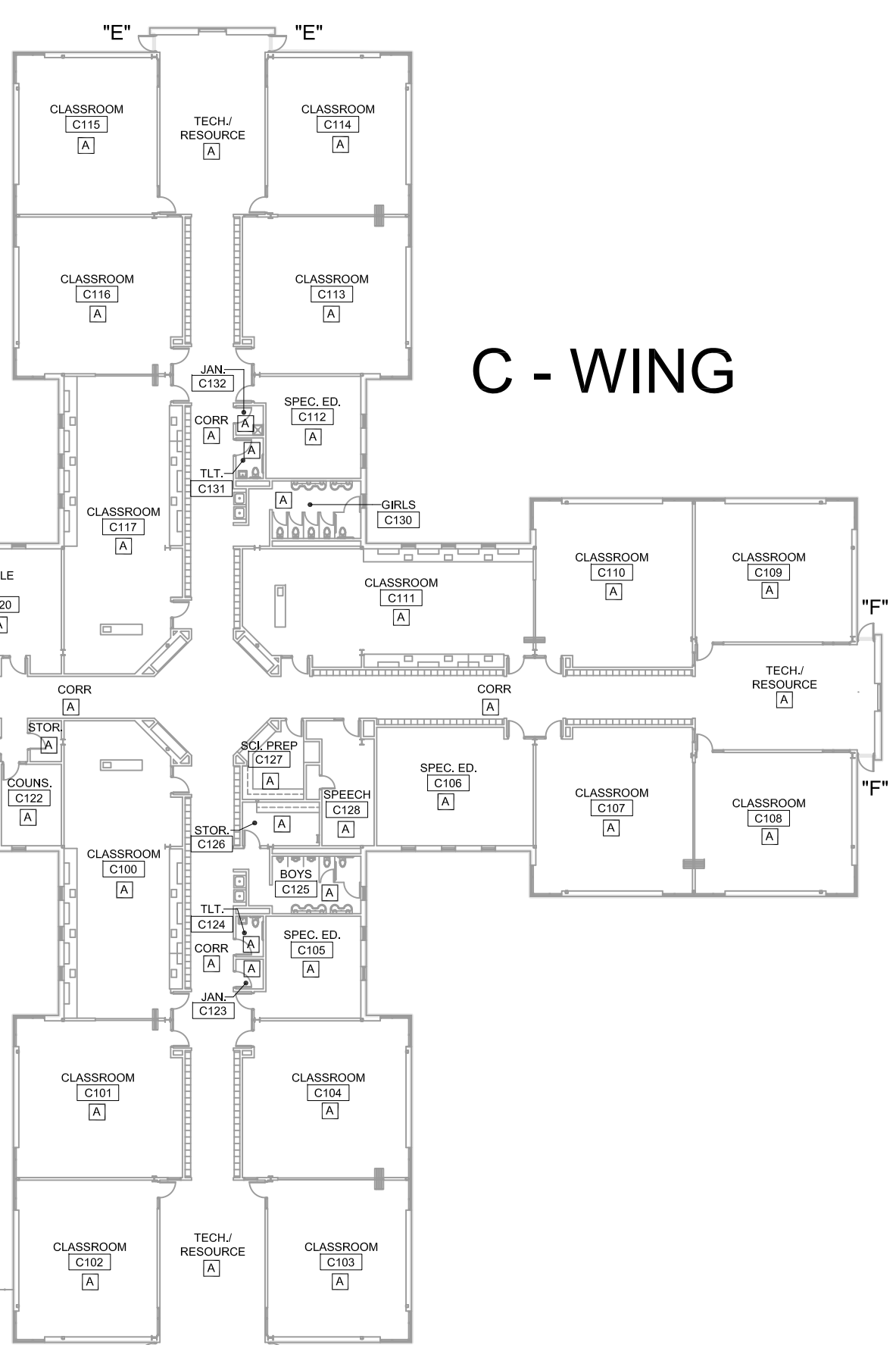

PT-1 SW-7004 SNOWBOUND  
PT-2 SW-7019 GAUNTLET GRAY  
PT-3 SW-6495 GREAT FALLS  
PT-4 SW-6717 LIME RICKY  
PT-5 SW-6601 TANAGER  
PT-6 SW-7016 MINDEUL GRAY